



Adding O₂

Summary of range characteristics

Covid19 epidemic period

03-2020

Introduction

- The addition of oxygen may be prescribed in addition to ventilation
- This guide aims to indicate the characteristics of each device for adding oxygen:
 - What maximum flow?
 - Where to place the O₂ on the machine?
 - FiO₂ setting possible or not?
 - FiO₂ monitoring possible or not?
- This guide is not intended as a recommendation for settings
- For more information, please refer to the user guide and instructions for each device.

Elisée 350

Adding O ₂	Elisée 350	
Flow O ₂	<p>High Pressure 240 to 700 kPa max ó 2,4 to 7 bar max at the rear of the device</p>	<p>Low pressure 400 kPa max ó 4 bar at the rear of the device</p>
FiO ₂ Setting	<p>Set from 21% to 100% at High pressure</p>	
FiO ₂ Monitoring	<p>Yes</p>	

High Pressure

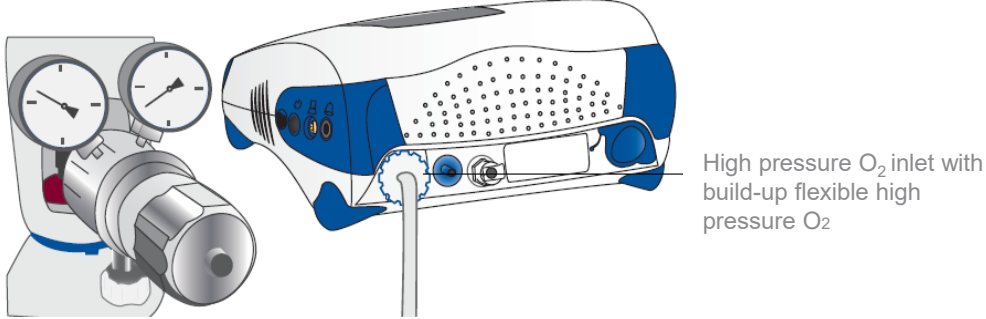

Low pressure

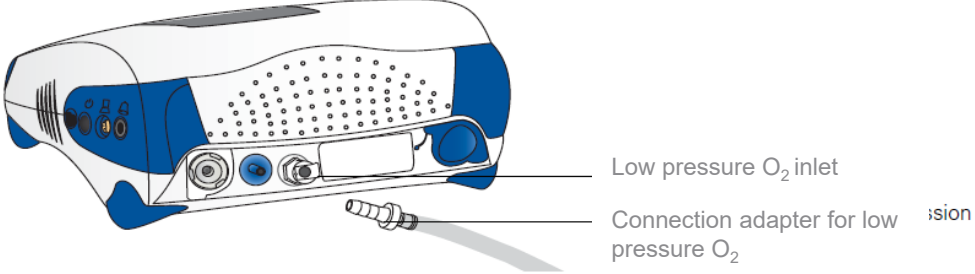

Disconnect all oxygen inlets when the device is in standby or turned off

Elisée 250

Adding O ₂	Elisée 250
Flow O ₂	<p>High pressure 240 to 700 kPa max ó 2,4 to 7 bar max at the rear of the device</p>
FiO ₂ setting	<p>Set from 21% to 100% at High pressure</p>
FiO ₂ Monitoring	<p>Yes</p>

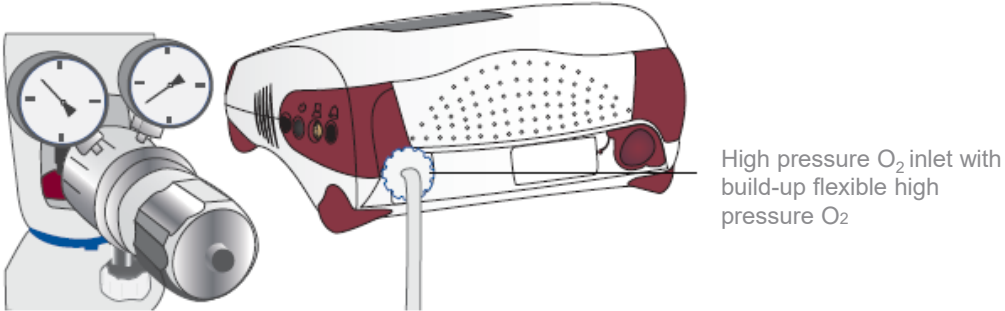

Disconnect all oxygen inlets when the device is on standby or turned off

Elisée 150

Adding O ₂	Elisée 150
Flow O ₂	Low pressure 400 kPa max 15 l/min max at the rear of the device
FiO ₂ setting	No
FiO ₂ Monitoring	Optional Réf CAP009379

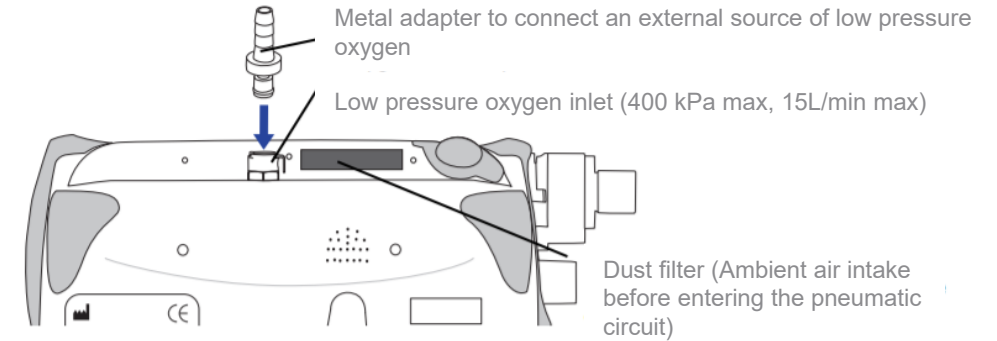

When the addition of oxygen is delivered at a fixed rate, the concentration of inhaled oxygen varies depending on

- Ventilation mode and settings
- Type of circuit used
- Patient breath pattern
- Mask chosen
- Unintentional leak value



- Connect oxygen only when ventilation has started and disconnect oxygen before stopping ventilation
- Disconnect the oxygen inlet when the device is on standby or turned off

VS III

Adding O ₂	VSIII
Flow O ₂	<p>Low pressure 400 kPa max 8 l/min max at the rear of the device</p> <p>NB: 14 l/min maximum if the flow trigger is used in a double limb circuit. However, beyond 8 l/min, the accuracy of the volumes delivered and measured by the respirator is no longer guaranteed.</p>
FiO ₂ setting	No
FiO ₂ Monitoring	<p>Oui en option Kit de monitoring sans la cellule à O₂ (Réf. KIT015015) Cellule O₂ (Réf. CAP008064)</p>

Low pressure O₂ inlet
400 kPa maximum, 8 L/min maximum

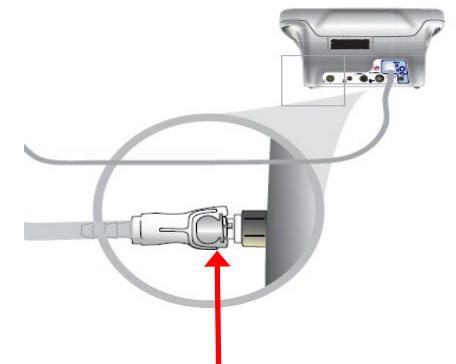
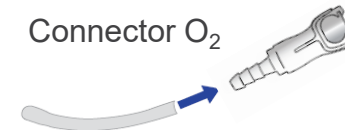

Press the metal tab
to release the O₂ connector

When the addition of oxygen is delivered at a fixed rate, the concentration of inhaled oxygen varies depending on

- Ventilation mode and settings
- Type of circuit used
- Patient breath pattern
- Mask chosen
- Unintentional leak value



- Connect oxygen only when ventilation has started and disconnect oxygen before stopping ventilation
- Disconnect the oxygen inlet when the device is on standby or turned off

ASTRAL 150 / 100

Adding O ₂	ASTRAL 150 / 100
Flow O ₂	30L/min maximum at the rear of the device O ₂ low pressure connector (Product code 24971) 
FiO ₂ setting	No
FiO ₂ Monitoring	Optional O ₂ Cell (Product code 27935)

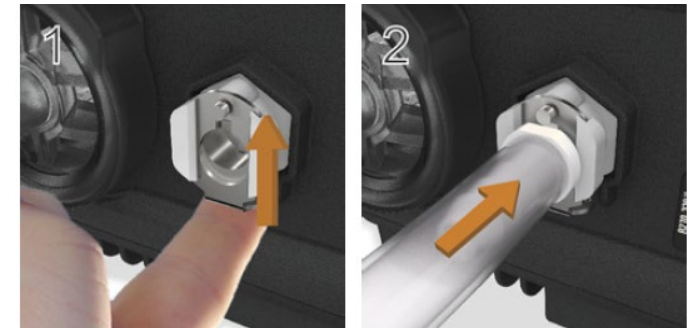

When the addition of oxygen is delivered at a fixed rate, the concentration of inhaled oxygen varies depending on

- Ventilation mode and settings
- Type of circuit used
- Patient breath pattern
- Mask chosen
- Unintentional leak value



- Connect oxygen only when ventilation has started and disconnect oxygen before stopping ventilation
- Disconnect the oxygen inlet when the device is on standby or turned off

STELLAR 150 / 100

Adding O ₂	STELLAR 150 / 100
Flow O ₂	<p>30L/min maximum at the rear of the device O₂ low pressure connector (Product code 24971)</p> 
FiO ₂ setting	No
FiO ₂ Monitoring	<p>Optional Control kit without O₂ cell (Product code 24955) O₂ Cell (Product code CAP008617)</p>

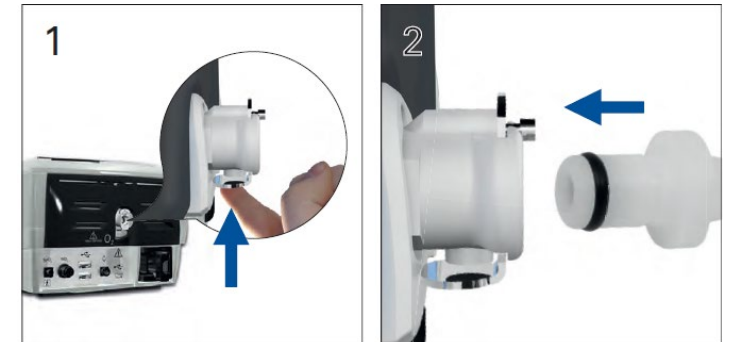
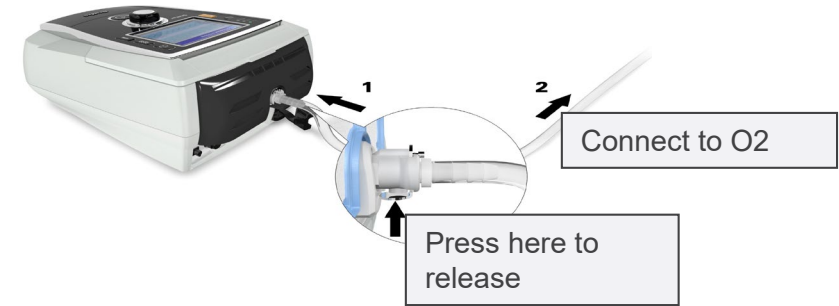

When the addition of oxygen is delivered at a fixed rate, the concentration of inhaled oxygen varies depending on

- Ventilation mode and settings
- Type of circuit used
- Patient breath pattern
- Mask chosen
- Unintentional leak value



- Connect oxygen only when ventilation has started and disconnect oxygen before stopping ventilation
- Disconnect the oxygen inlet when the device is on standby or turned off

LUMIS 150 / LUMIS 100

Adding O ₂	LUMIS 100 / LUMIS 150
Flow O ₂	<p>15 l/min maximum in all modes (except 4 l/min maximum in iVAPS mode) at the rear of the device: 2 options</p> <ul style="list-style-type: none"> • Heated circuit ClimateLine Air Oxy Ø 22 mm (with Ø 4 mm pressure used for oxygen inlet) Product code 37357 • O₂ Connector Product code 26960 or Product code 61121
FiO ₂ setting	No
FiO ₂ Monitoring	No



Connection O₂
Product code 26960



ClimateLineAir oxy
(connection build-up in circuit)

When the addition of oxygen is delivered at a fixed rate, the concentration of inhaled oxygen varies depending on

- Ventilation mode and settings
- Type of circuit used
- Patient breath pattern
- Mask chosen
- Unintentional leak value



- Connect oxygen only when ventilation has started and disconnect oxygen before stopping ventilation

AIRCURVE 10 VAuto

Adding O ₂	AIRCURVE 10 VAuto
Flow O ₂	<p>15 l/min maximum in S and CPAP modes (4 l/min in Vauto mode)</p> <p>at the rear of the device: 2 options</p> <ul style="list-style-type: none"> • Heated circuit ClimateLine Air Oxy Ø 22 mm (with Ø 4 mm pressure used for oxygen inlet) Product code 37357 • O₂ Connector Product code 26960 or Product code 
FiO ₂ setting	No
FiO ₂ Monitoring	No



Connection O₂
Product code 26960

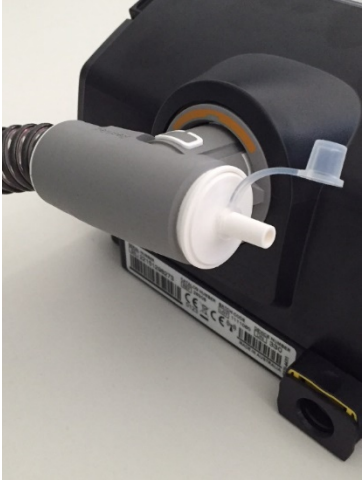

ClimateLineAir oxy
(inlet build-up in circuit)

When the addition of oxygen is delivered at a fixed rate, the concentration of inhaled oxygen varies depending on

- Ventilation mode and settings
- Type of circuit used
- Patient breath pattern
- Mask chosen
- Unintentional leak value



- Connect oxygen only when ventilation has started and disconnect oxygen before stopping ventilation
- ~~Disconnect the oxygen inlet when the device is on standby or turned off~~

AIRSENSE 10 / AIRSENSE 10 For Her

Adding O ₂	AIRSENSE 10 / AIRSENSE 10 For Her
Flow O ₂	<p>4 l/min maximum in all modes</p> <p>at the rear of the device: 2 options</p> <ul style="list-style-type: none"> • Heated circuit ClimateLine Air Oxy Ø 22 mm (with Ø 4 mm pressure used for oxygen inlet) Product code 37357  • O₂ Connector Product code 26960 or Product code 61121
FiO ₂ setting	No
FiO ₂ Monitoring	No



Connection O₂
Product code 26960



ClimateLineAir oxy
(inlet build-up in circuit)

When the addition of oxygen is delivered at a fixed rate, the concentration of inhaled oxygen varies depending on

- Ventilation mode and settings
- Type of circuit used
- Patient breath pattern
- Mask chosen
- Unintentional leak value



- Connect oxygen only when ventilation has started and disconnect oxygen before stopping ventilation
- Disconnect the oxygen inlet when the device is on standby or turned off

Mentions & disclaimer

24/03/20

COVID-19

Adding O₂ - Summary of range characteristics

This document is based on information available at the time of publication

Document No: 110259. Copyright ResMed